

REMOVAL AND INSTALLATION

REMOVAL

- 1. Using a trim stick or equivalent, release the retaining clips (1b) and remove the floor console front side cover (1a).

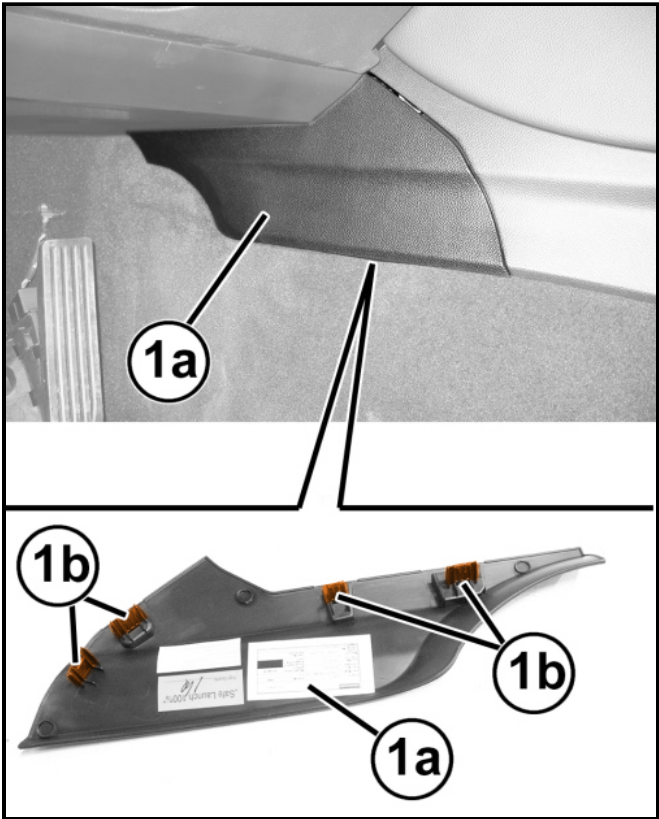

- 2. Using a trim stick or equivalent, release the retaining clips (1c and 2a) and remove the instrument panel side cover (1b).

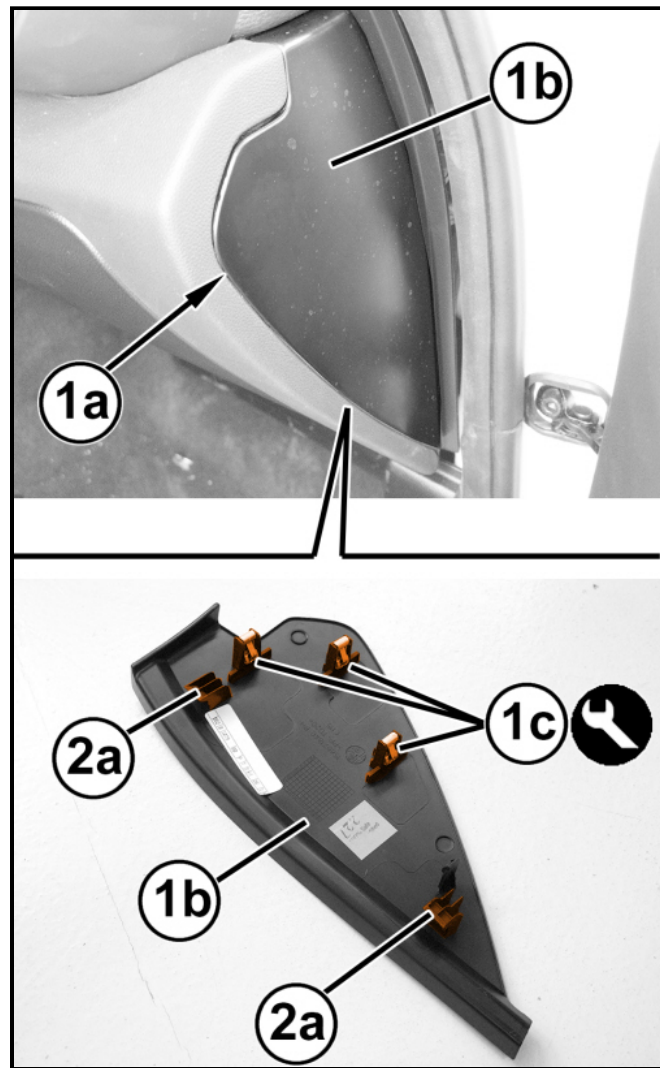

3. Working under the glove box, remove the screws (3a) from the passenger side silencer panel (2a).
4. Lower the silencer panel (2a) and disconnect the wire harness connectors (1a and 1b).

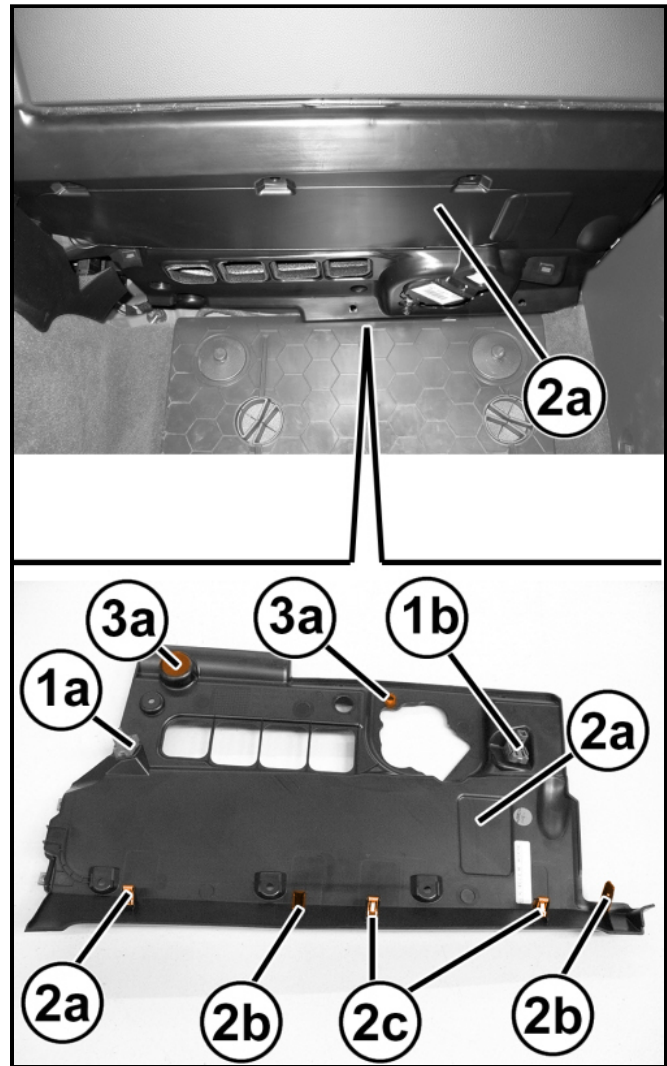

5. Open the glove box door (1b) and remove the screws (1a).

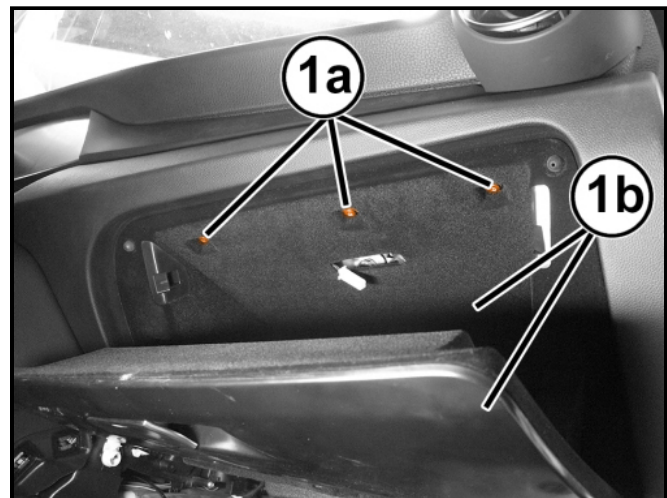

6. Close the glove box door (1a) and remove the screws (1b).

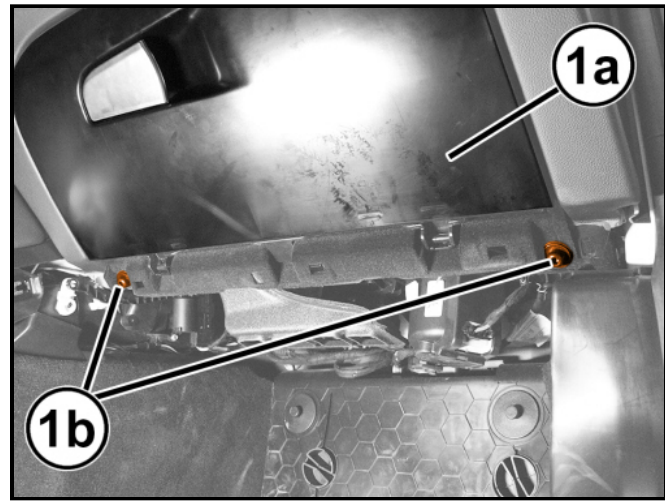

7. Using a trim stick or equivalent, release the retaining clips (1b) and loosen the glove box (3).

NOTE: If the vehicle is equipped with Cooled Glove Box take care to remove the vent tube from the glove box before removing the assembly.

8. Pull the glove box out and disconnect the wire harness connector (2a).

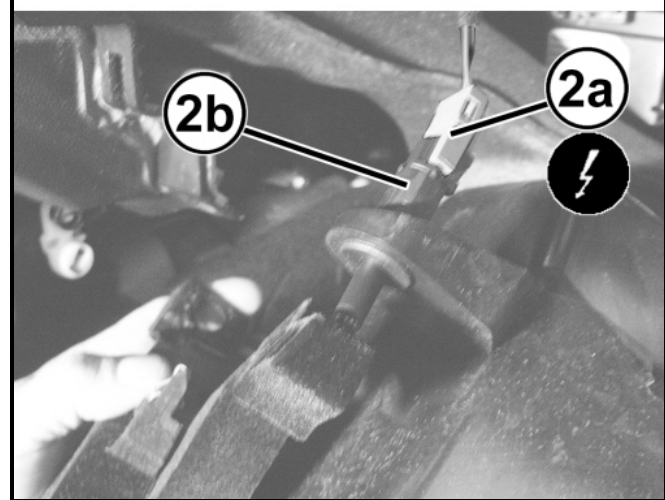
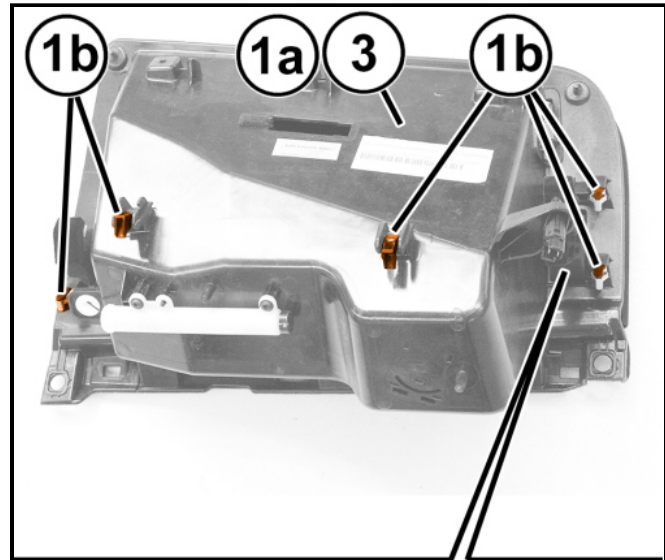

9. If it is necessary to remove the glove box limiter (1c), remove the screws (2a) then remove the rope (1b) from the retainer (1a).

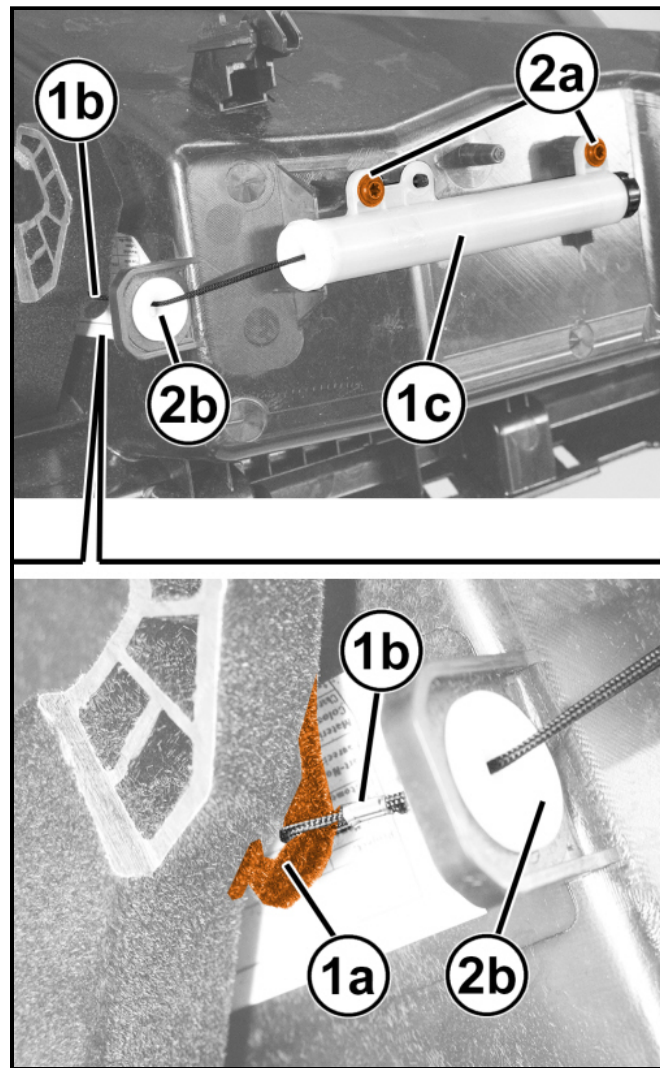

INSTALLATION

1. If it is necessary to install the glove box limiter (1c), install the rope (1b) to the retainer (1a) then install the screws (2a).

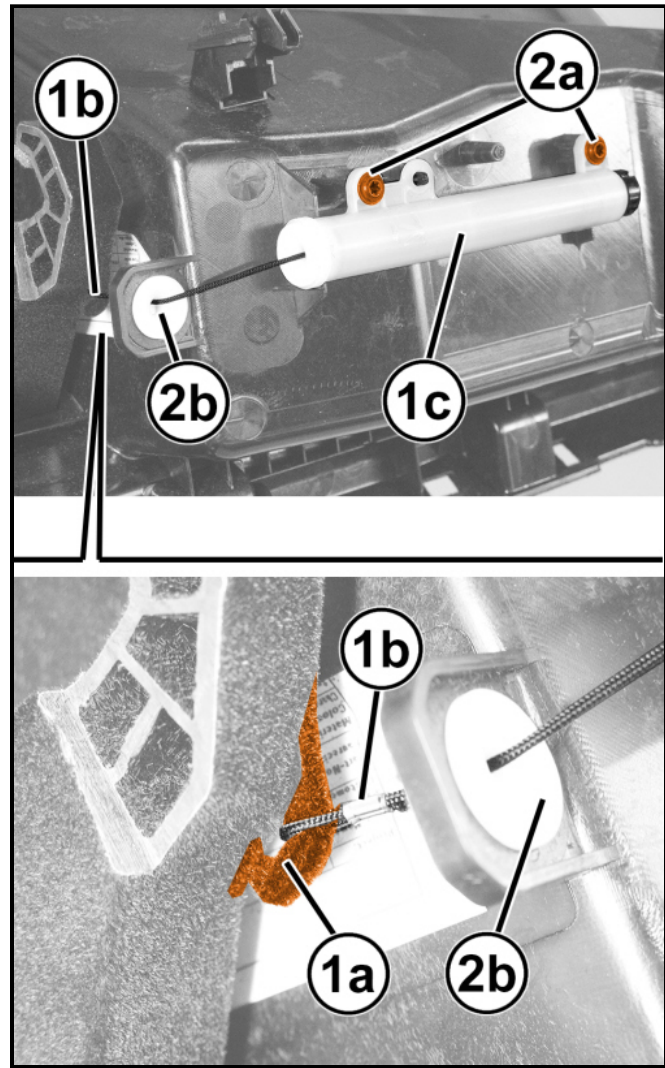

2. Position the glove box assembly (3) near the instrument panel and connect the wire harness connector (2a).
3. Position the glove box assembly into the instrument panel and hand tap to engage the retaining clips (1b).

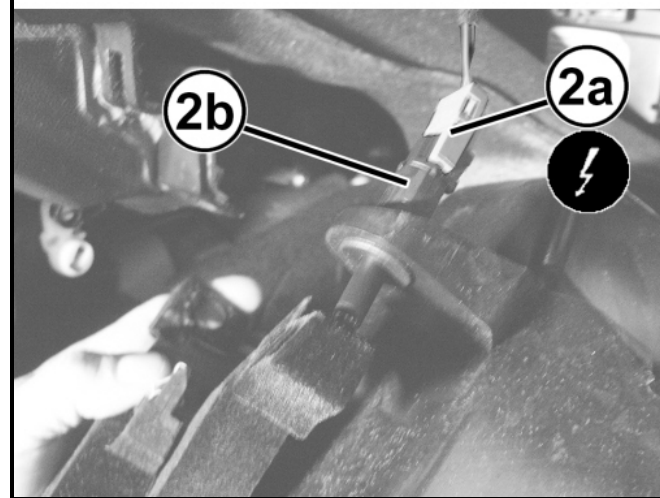
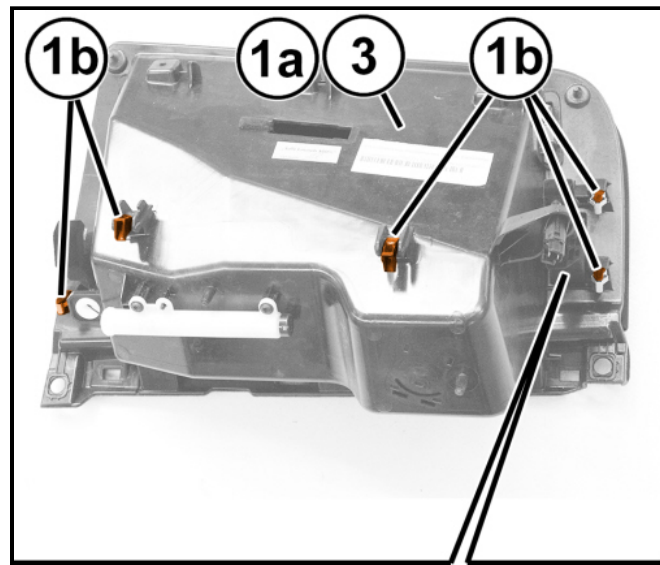

4. Install the screws (1b) and tighten securely.

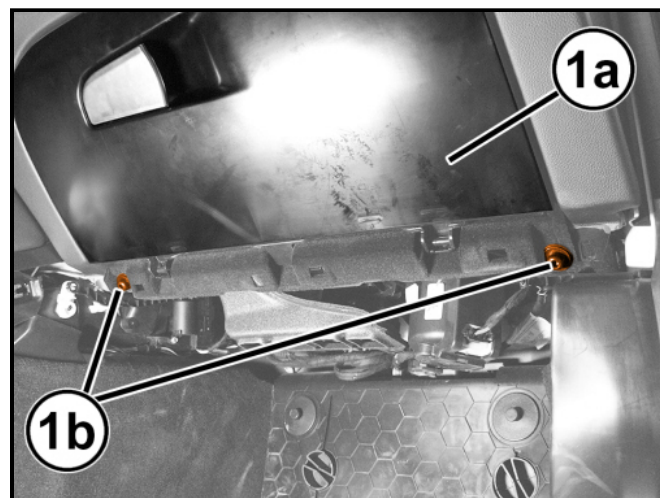

5. Open the glove box door (1b) and install the screws (1a). Tighten the screws securely.

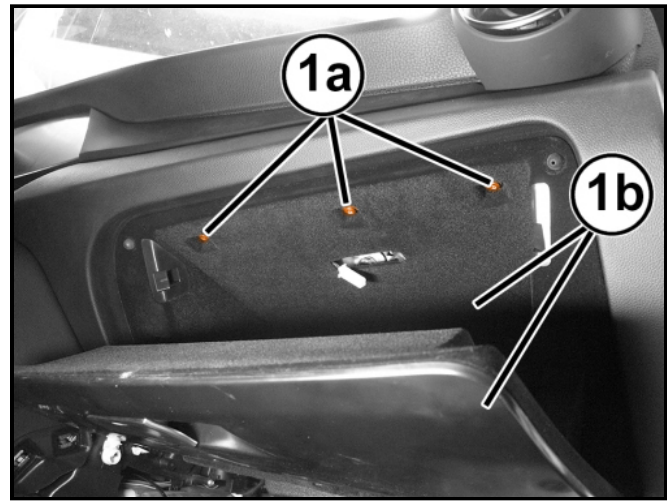

6. Install the silencer panel (2a).

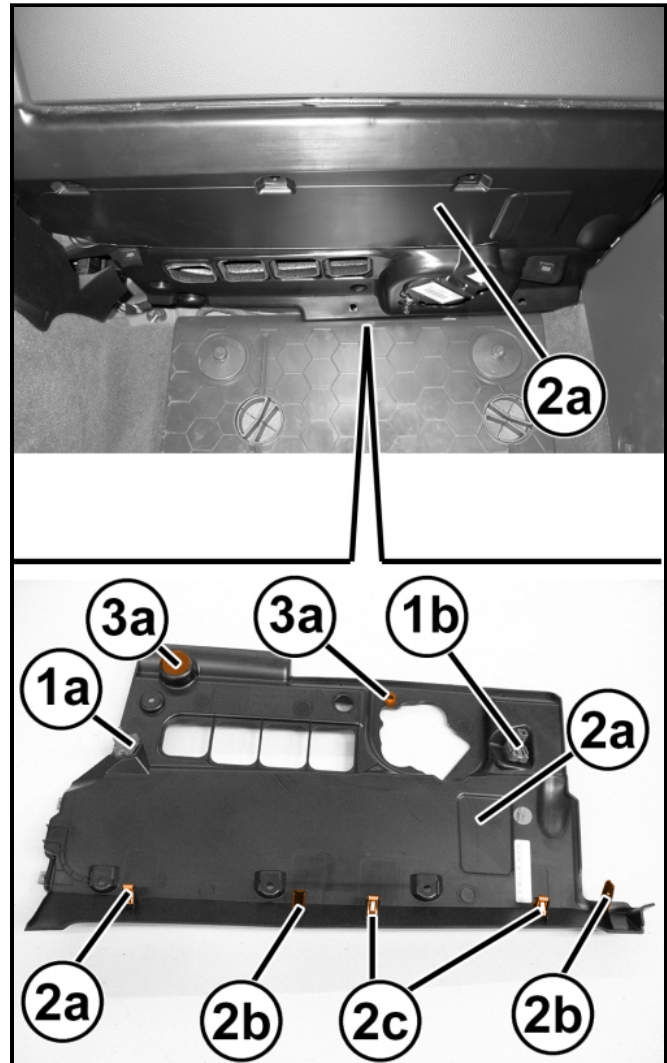

7. Install the instrument panel side cover (1b).

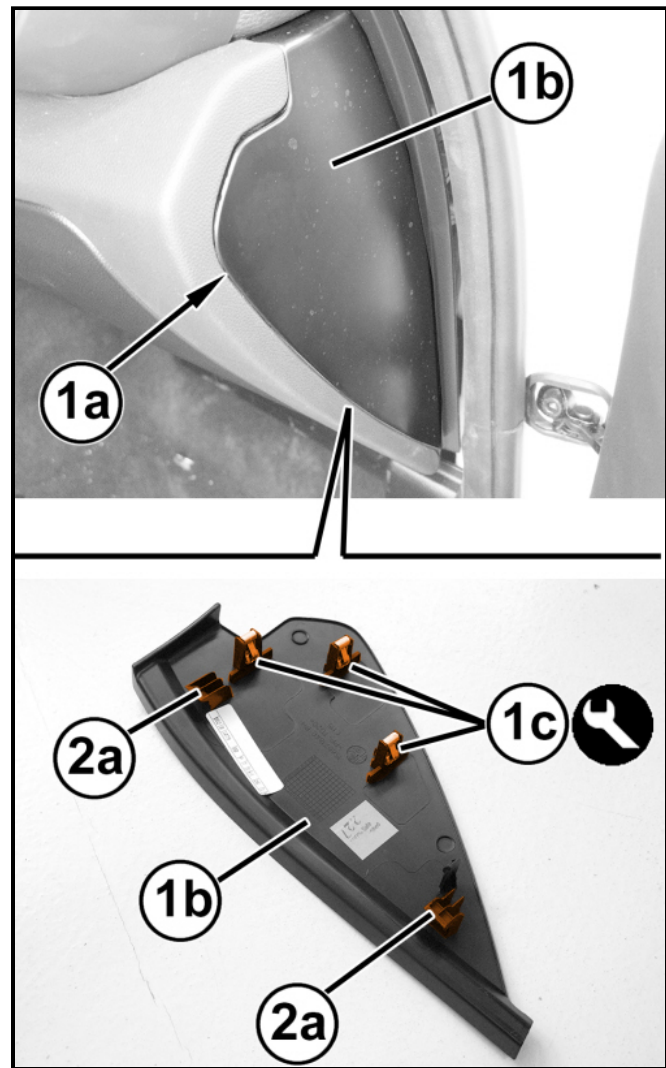

8. Install the floor console front side cover (1a).

