

## Components

Depending on the version, on the steering wheel - apart from the Air Bag module and horn - there are the radio electrical controls and, on Selespeed versions, the levers for the electrical controls of the gearbox. Characteristic of working principle [2127A hydraulic transmission external linkage](#).

VIEW OF ELECTRICAL CONTROLS ON STEERING WHEEL IN 'BASIC' CONFIGURATION

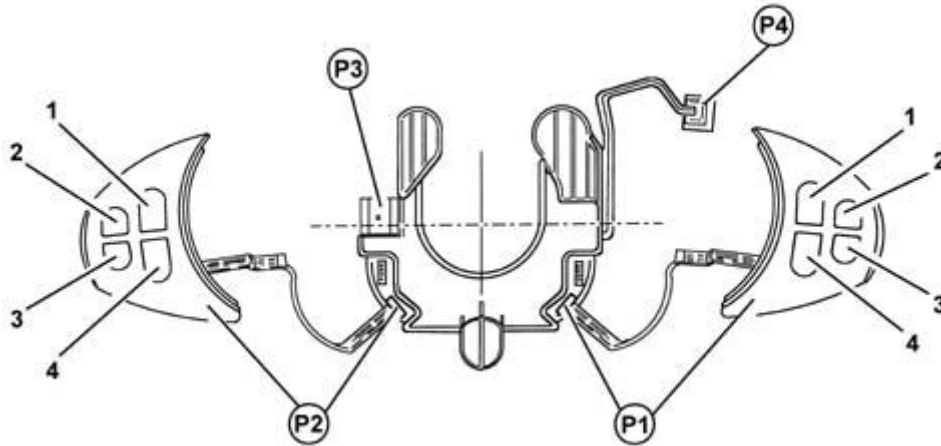

P1 - Right radio controls embellishment

1 - Scan + control

2 - Source control

3 - Not used

4 - Scan - control

P2 - Left radio controls embellishment

1 - Volume + control

2 - Mute control

3 - Not used

4 - Volume - control

P3 - Electrical system junction box

P4 - Horn connection

SUMMARY DIAGRAM OF CONNECTIONS IN BASIC CONFIGURATION

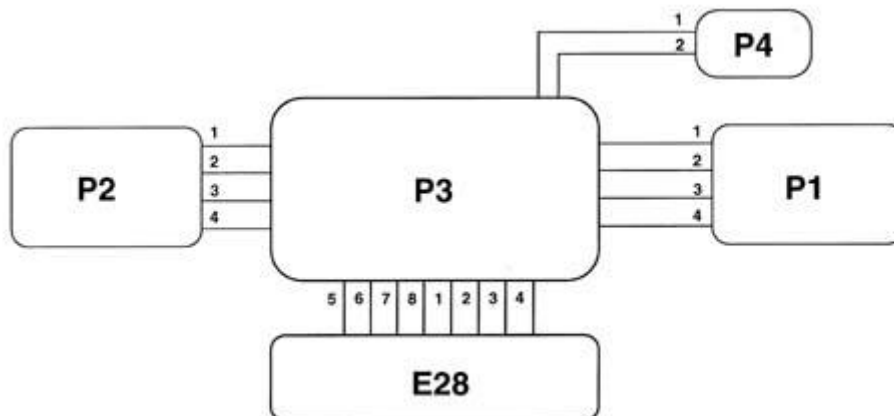

P1 - Right radio controls embellishment

Pin 1 - Illumination LED supply

Pin 2 - Illumination LED earth  
 Pin 3 - Signal for radio control RS1  
 Pin 4 - Earth for control signal  
 P2 - Left radio controls embellishment  
 Pin 1 - Illumination LED supply  
 Pin 2 - Illumination LED earth  
 Pin 3 - Signal for radio control RS2  
 Pin 4 - Earth for control signal  
 P3 - Electrical system junction box  
 Pin 1 - RS1 signal  
 Pin 2 - +15  
 Pin 3 - Not connected  
 Pin 4 - Not connected  
 Pin 5 - RS2 signal  
 Pin 6 - Earth  
 Pin 7 - Horn  
 Pin 8 - Earth for RS1/RS2 signals  
 P4 - Horn connection  
 Pin 1 - Horn control  
 Pin 2 - Control signal earth  
 E28 - Clockspring

#### WIRING DIAGRAM OF 'BASIC' CONFIGURATION

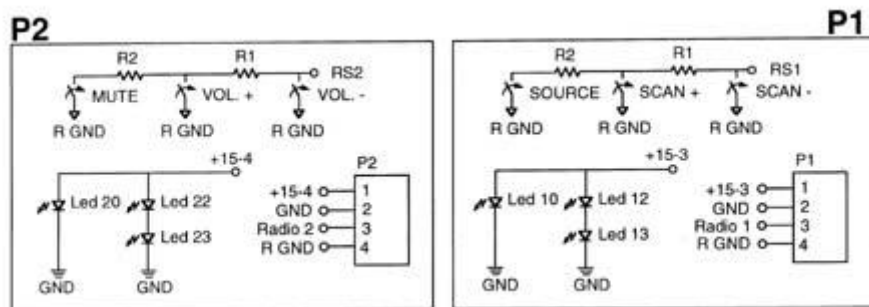

P1 - Right radio controls embellishment  
 P2 - Left radio controls embellishment  
 R1 - 100 ohm resistor  
 R2 - 220 ohm resistor

#### VIEW OF ELECTRICAL CONTROLS ON STEERING WHEEL IN 'PLUS' CONFORMATION

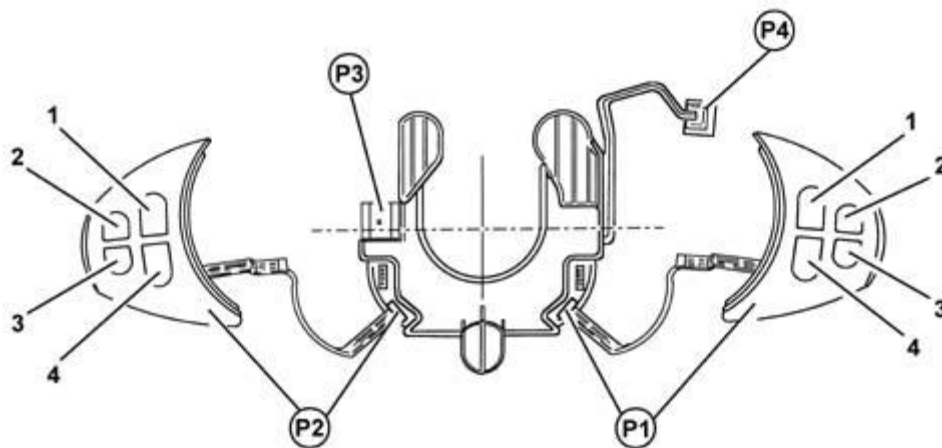

P1 - Right radio controls embellishment

1 - Scan + control

2 - Source control

3 - Telephone control

4 - Scan - control

P2 - Left radio controls embellishment

1 - Volume + control

2 - Mute control

3 - Voice control

4 - Volume - control

P3 - Electrical system junction box

P4 - Horn connection

SUMMARY DIAGRAM OF CONNECTIONS IN 'PLUS' CONFIGURATION

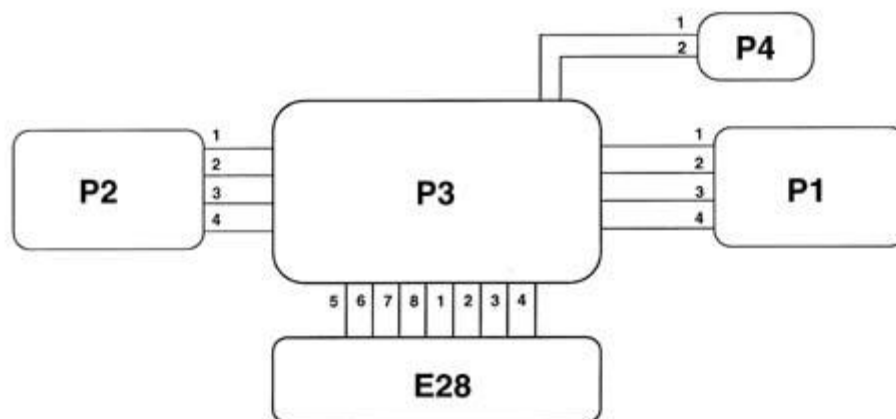

P1 - Right radio controls embellishment

Pin 1 - Illumination LED supply

Pin 2 - Illumination LED earth

Pin 3 - Signal for radio control/telephone RS1

Pin 4 - Earth for control signal

P2 - Left radio controls embellishment

Pin 1 - Illumination LED supply

Pin 2 - Illumination LED earth

Pin 3 - Signal for radio control speech recognition RS2

Pin 4 - Earth for control signal

P3 - Electrical system junction box

Pin 1 - RS1 signal

Pin 2 - + 15

Pin 3 - Not connected

Pin 4 - Not connected

Pin 5 - RS2 signal

Pin 6 - Earth

Pin 7 - Horn

Pin 8 - Earth for RS1/RS2 signals

P4 - Horn connection

Pin 1 - Horn control

Pin 2 - Control signal earth

E28 - Clockspring

### WIRING DIAGRAM FOR 'PLUS' CONFIGURATION

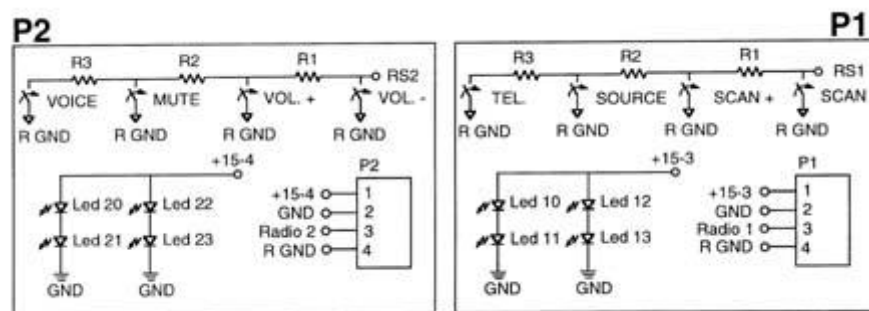

P1 - Right radio controls embellishment

P2 - Left radio controls embellishment

R1 - 100 ohm resistor

R2 - 220 ohm resistor

R3 - 680 ohm resistor

### VIEW OF ELECTRICAL CONTROLS ON STEERING WHEEL IN 'SELESPEED' CONFIGURATION

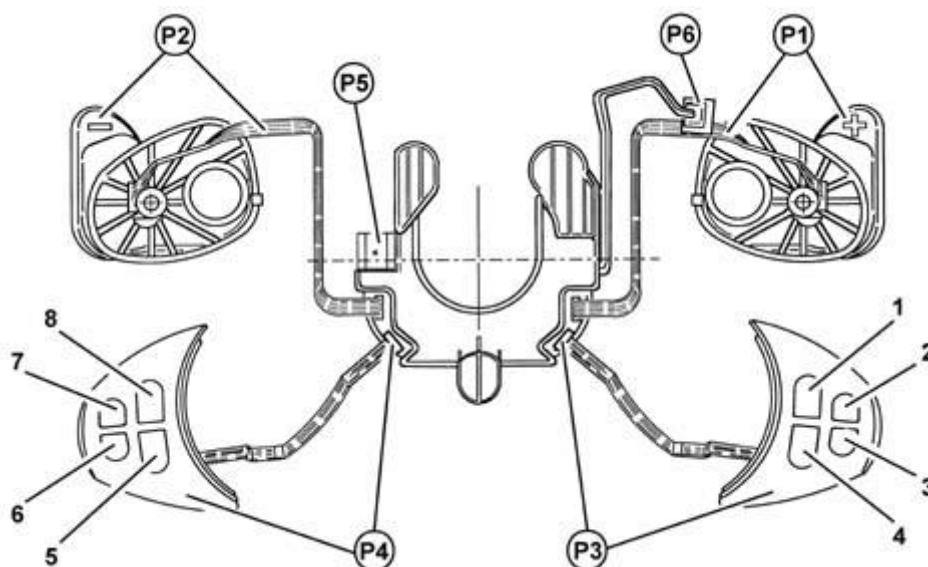

P1 - Upward shift control lever (1...5)

P2 - Downward shift control lever (5...1)

P3 - Right radio controls embellishment

1 - Scan + control

2 - Source control

3 - Telephone control

4 - Scan - control

P4 - Left radio controls embellishment

1 - Volume + control

2 - Mute control

3 - Voice control

4 - Volume - control

P5 - Electrical system junction box

P6 - Horn connection

SUMMARY DIAGRAM OF CONNECTIONS IN 'SELESPEED' CONFIGURATION

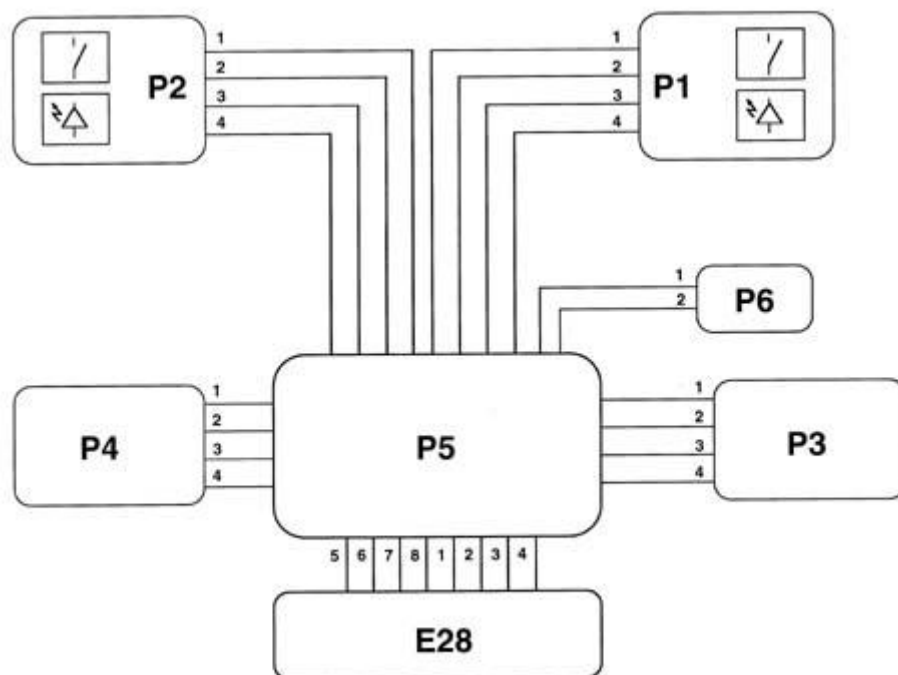

P1 - Upward shift control lever (1...5)

Pin 1 - Illumination LED supply

Pin 2 - Illumination LED earth

Pin 3 - Gear control signal (1...5)

Pin 4 - Earth for gear control signal

P2 - Downward shift control lever (5...1)

Pin 1 - Illumination LED supply

Pin 2 - Illumination LED earth

Pin 3 - Gear control signal (5...1)

Pin 4 - Earth for gear control signal

P3 - Right radio controls embellishment

Pin 1 - Illumination LED supply

Pin 2 - Illumination LED earth

Pin 3 - Signal for radio control/telephone RS1

Pin 4 - Earth for control signal

P4 - Left radio controls embellishment  
 Pin 1 - Illumination LED supply  
 Pin 2 - Illumination LED earth  
 Pin 3 - Signal for radio control speech recognition RS2  
 Pin 4 - Earth for control signal  
 P5 - Electrical system junction box  
 Pin 1 - RS1 signal  
 Pin 2 - +15  
 Pin 3 - Gear control signal earth  
 Pin 4 - Gear control signal  
 Pin 5 - RS2 signal  
 Pin 6 - Earth  
 Pin 7 - Horn  
 Pin 8 - Earth for RS1/RS2 signals  
 P6 - Horn connection  
 Pin 1 - Horn control  
 Pin 2 - Control signal earth  
 E28 - Clockspring

## WIRING DIAGRAM OF 'SELESPEED' CONFIGURATION

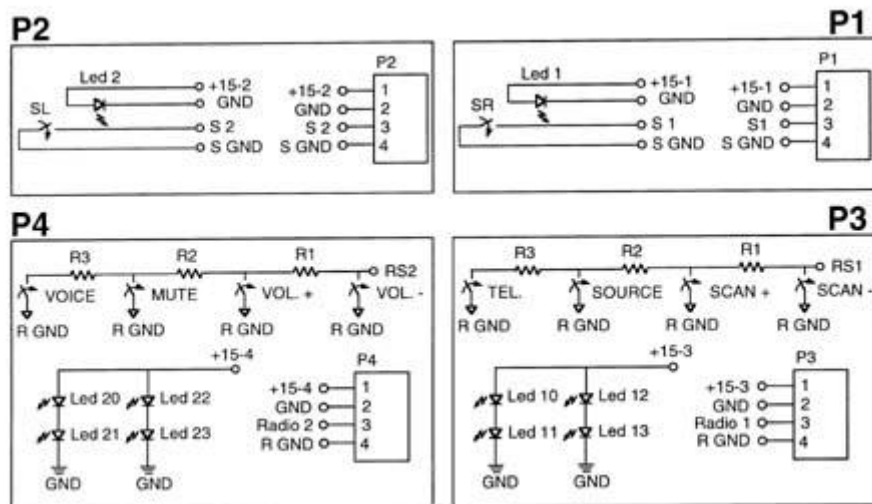

P1 - Upward shift control lever (1...5)  
 P2 - Downward shift control lever (5...1)  
 P3 - Right radio controls embellishment  
 P4 - Left radio controls embellishment  
 R1 - 100 ohm resistor  
 R2 - 220 ohm resistor  
 R3 - 680 ohm resistor

## Junction box

VIEW OF PIN OUT

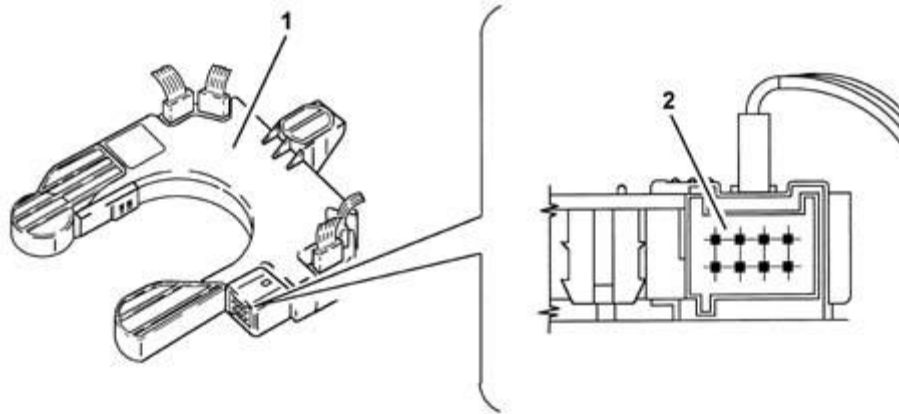

1 - Junction box

2 - Pin out

The connection to the electrical system is via a junction box, located on the bottom of the Air Bag module housing.

On the box, to which all the electrical functions of the steering wheel lead, there is an 8-pin connector which is connected to the corresponding connector emerging from the clock spring  
Characteristic of working principle [5580C air bag system](#).